

RAGUSA CENTRO

PIANO TERZO VIA MONS. A. RIZZO
(PIANO A QUOTA 525,15)

5

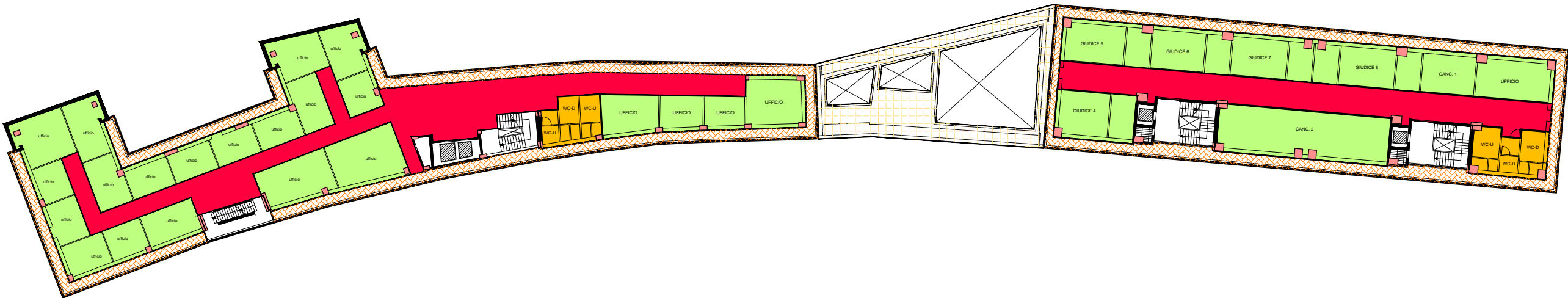

	UFFICI TRIBUNALE	mq	927,48
	CORRIDOI	mq	425,65
	WC	mq	74,35
	BALCONI CHIUSI	mq	392,56
	SPAZIO ESTERNO	mq	157,19